

**Low-E CARD+<sup>®</sup>**  
COATING DETECTOR

#AE2250

with replaceable battery



**Low-ECARD.com**

AE2250 Low-E CARD+® provides a simple and convenient way to determine if there is a Low-E coating present on a piece of glass, and identifies which surface is coated.

#### OPERATING INSTRUCTIONS

1. Place the Low-E CARD+® flat against glass.
2. Using one finger, press the power button. *Do not touch the Low-E CARD+® or glass with other fingers or hands.* The battery indicator light will blink once to show testing is in progress.

● Green LED = clear glass; no Low-E

● Red LED = Low-E on surface 1

● Yellow LED = Low-E on surface 2

⚡ The low battery indicator will blink repeatedly during testing near end of battery life, and will remain lit solidly when replacement is needed.

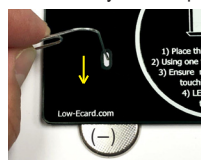
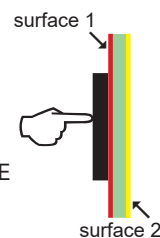

To replace the battery, place the Low-E CARD+® label side down. Locate the notch and use a paperclip to remove the battery by pulling paperclip toward lower edge of card. Place a new battery in positive (+) side down.

For double pane windows, test the first piece of glass then place the card on the other side of the window to complete the test.

 edtm.com

**Low-ECARD.com**